

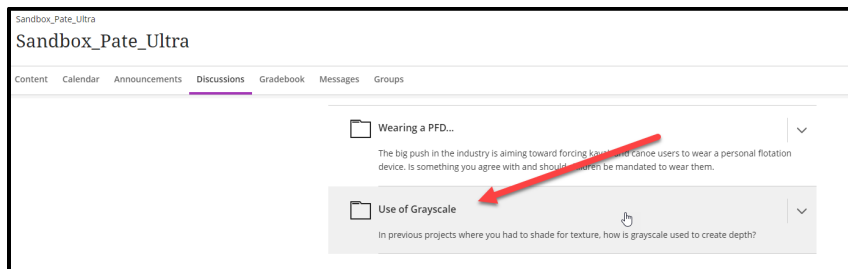

## Adding Video to a Discussion Board Question Using Express Capture within Kaltura

### Ultra Version

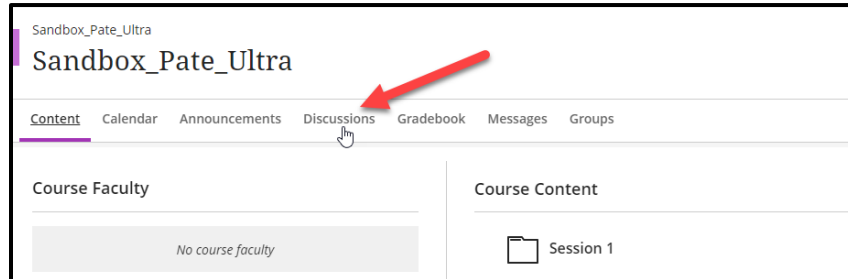

The first step in placing a live video capture using **Kaltura** is to locate the discussion and select it. In this example I am using the **“Use of Grayscale”** as the discussion in need of a video captured in **Express Capture**. You will choose your discussion question.

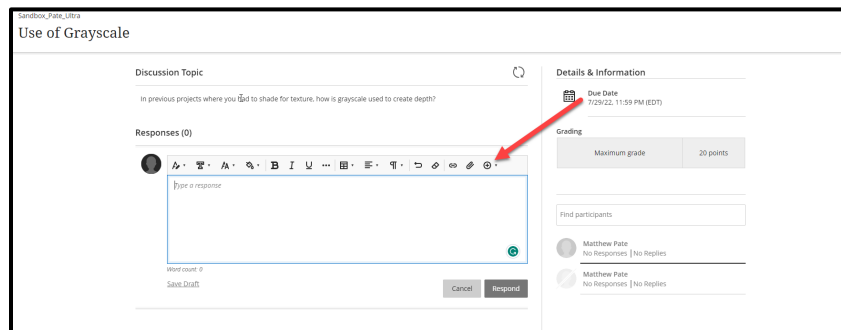

In Bb Ultra, you will select the **Responses** window and your tools will open with your formatting and content options. Choose the + sign and proceed down to **Content Market**.

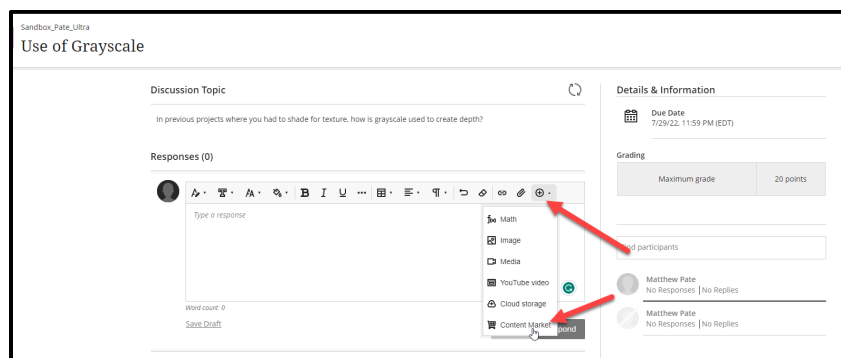



## Learn Version

FORUM	DESCRIPTION	TOTAL POSTS	UNREAD POSTS	UNREAD REPLIES TO ME	TOTAL PARTICIPANTS
Wearing a PFD	The big push in the industry is aiming toward forcing kayak and canoe users to wear a personal flotation device. Is something you agree with and should children be mandated to wear them?	1	1	0	1
Use of Grayscale	In previous projects where you had to shade for texture, how is grayscale used to create depth?	1	1	0	1

Forum: Use of Grayscale

Organize Forum Threads on this page and apply settings to several or all threads. Threads are listed in a tabular format. The Threads can be sorted by clicking the column title or the caret at the top of each column. [More Help](#)

This is a 'post-first' discussion forum.

There is currently 1 thread in this forum. Join the conversation by creating a thread!

[Create Thread](#)

FORUM DESCRIPTION

In previous projects where you had to shade for texture, how is grayscale used to create depth?

In Bb Original Learn you would select the title “Use of Graycale” and click **Create Forum**.

FORUM DESCRIPTION

In previous projects where you had to shade for texture, how is grayscale used to create depth?

MESSAGE

Subject:

Message

For the toolbar, press ALT+F10 (PC) or ALT+FN+F10 (Mac).

Message toolbar: Bold, Italic, Underline, Paragraph, Arial, 10pt, Bulleted List, Numbered List, Indent Left, Indent Right, Decrease Indent, Increase Indent, Undo, Redo, Link, Unlink, Image, Table, Table of Contents, Print, Close, Help, and a plus sign.

ATTACHMENTS

Attach File: [Browse Local Files](#) [Browse Content Collection](#)

Click **Save Draft** to save a draft of this message. Click **Submit** to submit the post. Click **Cancel** to quit.

Buttons: [Cancel](#) [Save Draft](#) [Submit](#)

Next, you will add a title to your forum subject and then choose the + sign on the formatting toolbar with the Message window.



Each Bb version will require the user to select Kaltura Embed. These both work the same way, but the access screen is a bit different.

### Ultra Version

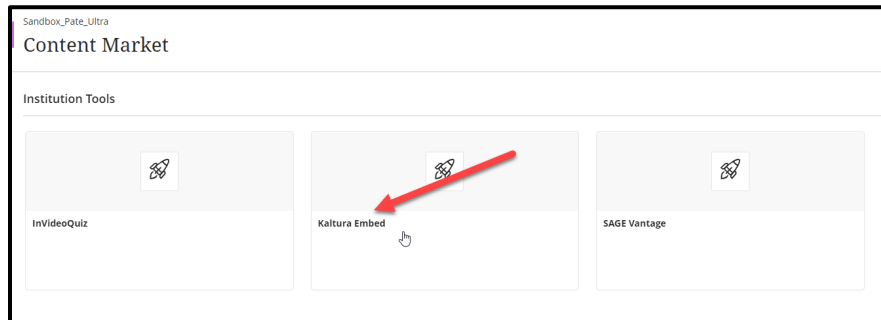

### Original Learn Version

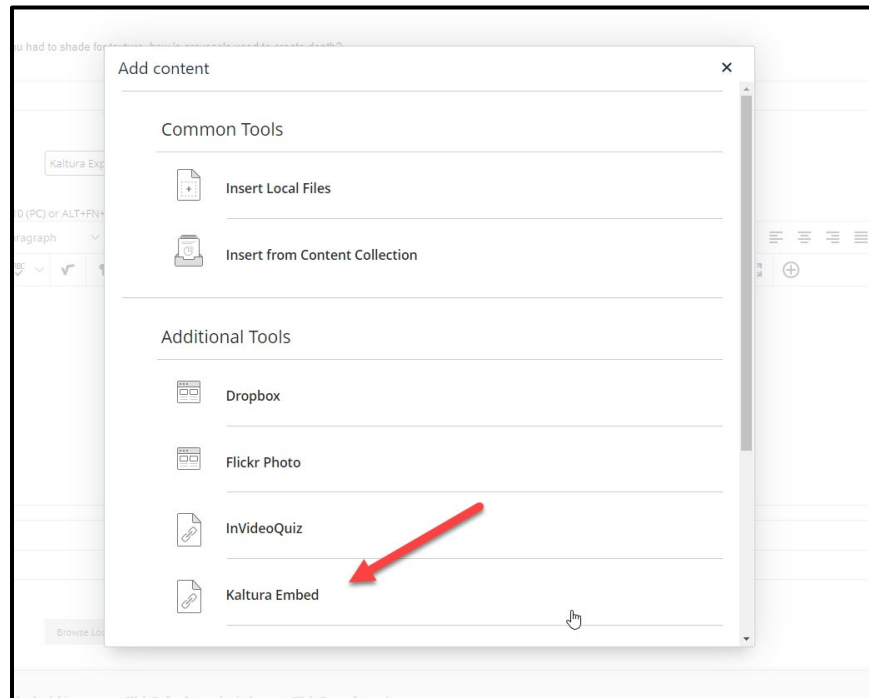

Once you have chosen Kaltura Embed you will select **+ Add New**. Both platform versions will access this the same way with only subtle changes to the interface.

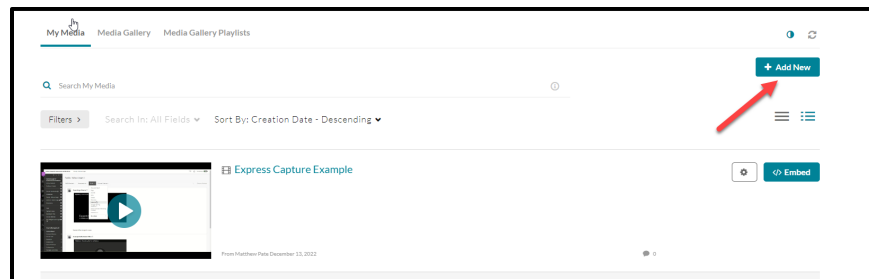



### Ultra Version

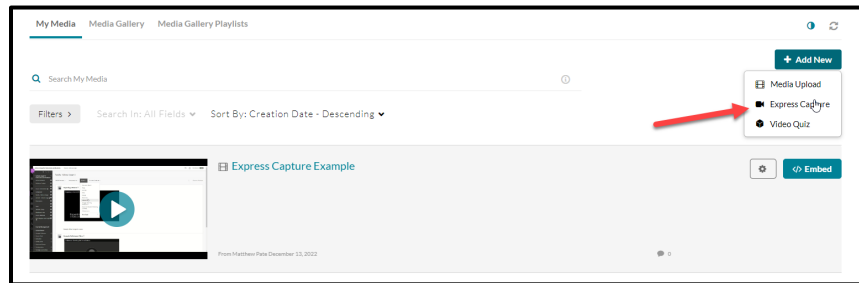

### Original Learn Version

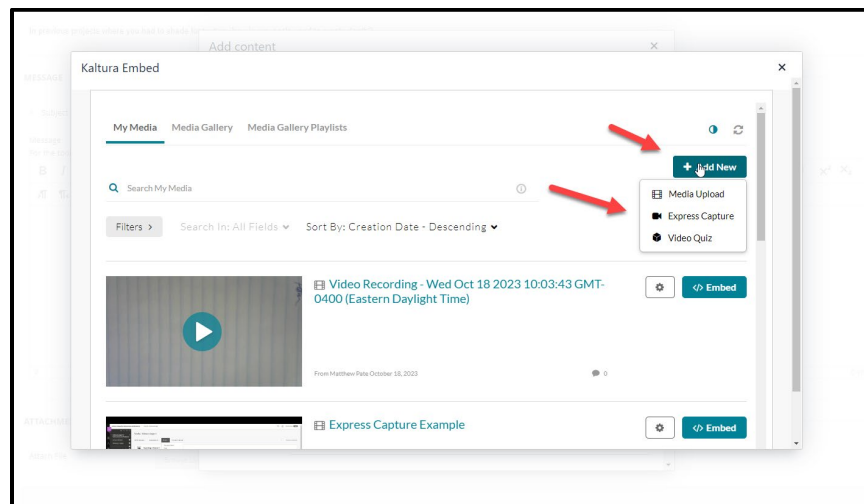

Next, you will select **Express Capture** and the recording window will appear. You will be prompted for access to the camera and microphone the first time you are using this feature. Make sure you allow these features. Your video image will appear from your webcam.

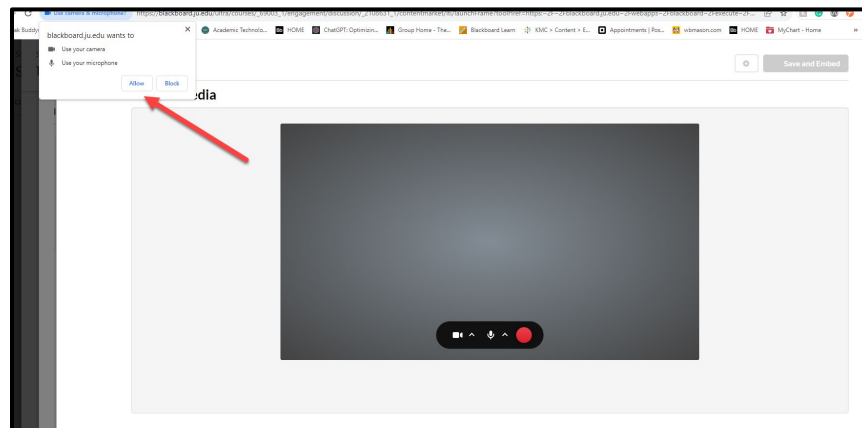

You will click the red circle to record your session and then once again to stop the recording.

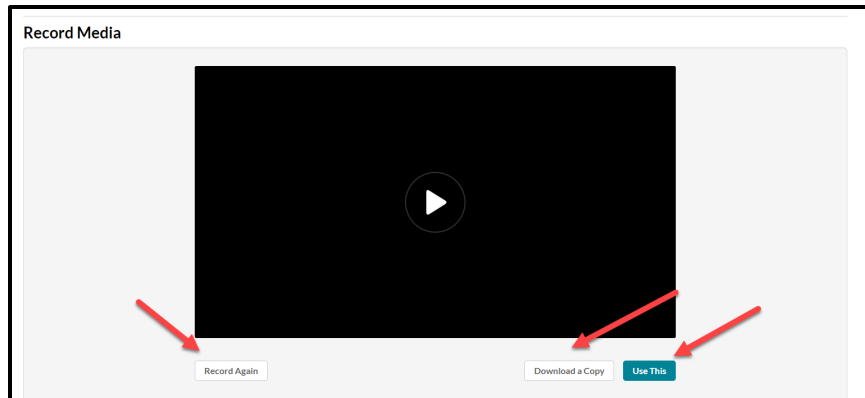

Once complete you have the option to **Record Again, Download a Copy, or Use This**. Select **Use This** once the video is previewed and acceptable to get to the description window in Ultra. You can add any commentary and explanatory notes needed or simply click **Save and Embed**.

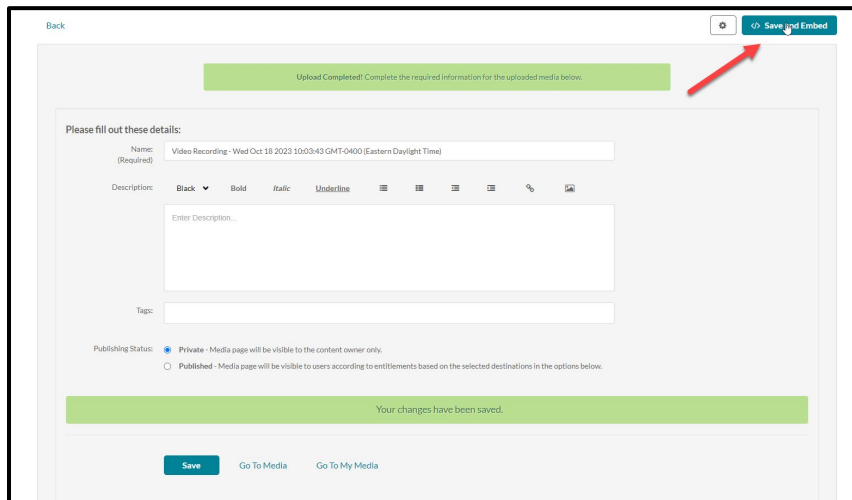

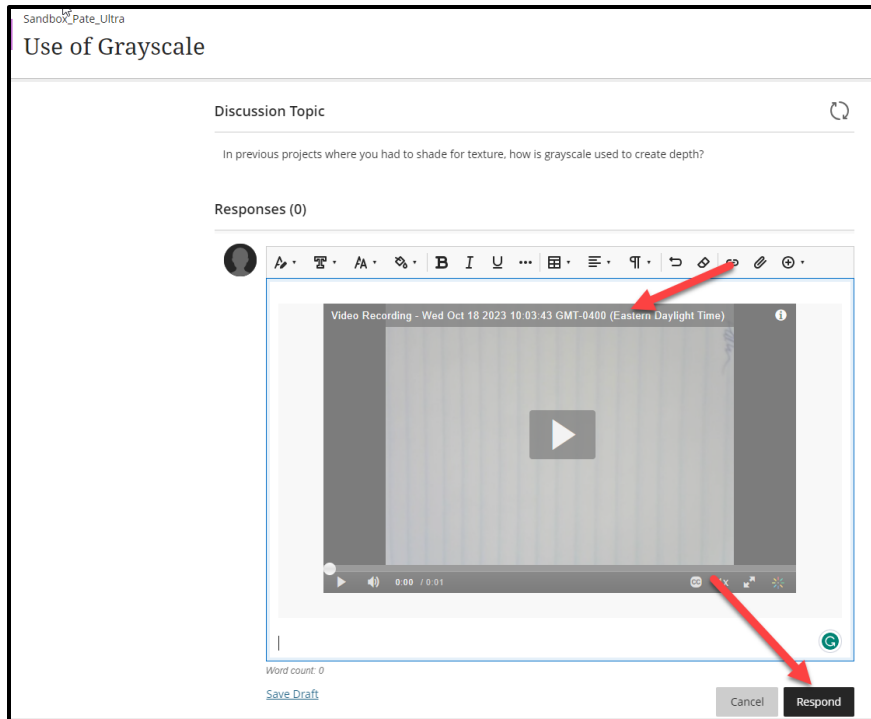

Click **Respond** to add the **Express Capture** video to the **Discussion** thread in Ultra.

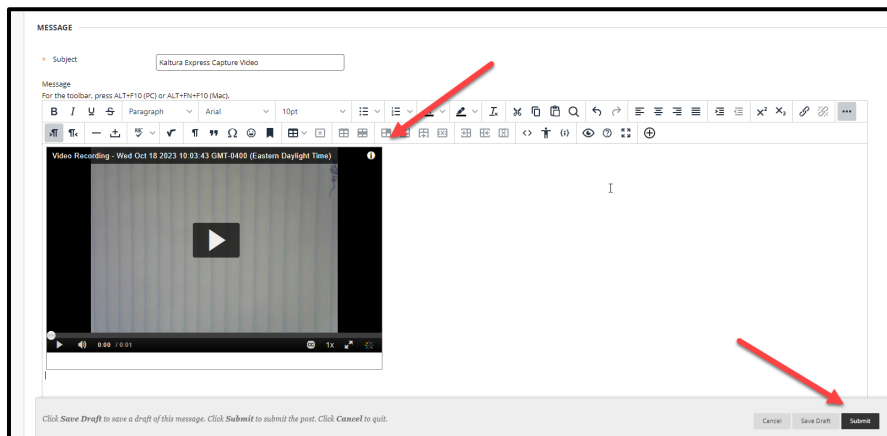

Click **Submit** to add the **Express Capture** video to the **Discussion** thread in Original Learn.



*Ultra Version Submission Window*

The screenshot shows a discussion window titled "Use of Grayscale". The discussion topic is "In previous projects where you had to shade for texture, how is grayscale used to create depth?". There is one response from Matthew Pate, which is a video recording titled "Video Recording - Wed Oct 18 2023 10:03:43 GMT-0400 (Eastern Daylight Time)". The video player shows a grayscale image of a textured surface. The right sidebar contains "Details & Information" with a due date of 7/29/22, 11:59 PM (EDT), and a grading section showing a maximum grade of 20 points. Below the video, there are controls for "Find participants" and a list of participants: Matthew Pate (1 Response | No Replies) and another Matthew Pate (No Responses | No Replies).

*Original Learn Submission Window*

The screenshot shows a thread titled "Thread: Kaltura Express Capture Video". At the top, there are controls for "Select: All | None", "Message Actions", "Expand All", and "Collapse All". The main content is a message from Matthew Pate titled "Kaltura Express Capture Video". The message contains a video recording titled "Video Recording - Wed Oct 18 2023 10:03:43 GMT-0400 (Eastern Daylight Time)". The video player shows a grayscale image of a textured surface. Below the video is a "Reply" button. At the bottom, there are controls for "Select: All | None", "Message Actions", "Expand All", and "Collapse All".

The submitted video now shows up within the **Discussion** as your response.